

CL Challenger Lifts

Floor Service Jack – 3-Ton Capacity (CLHMFSJ-60Q)

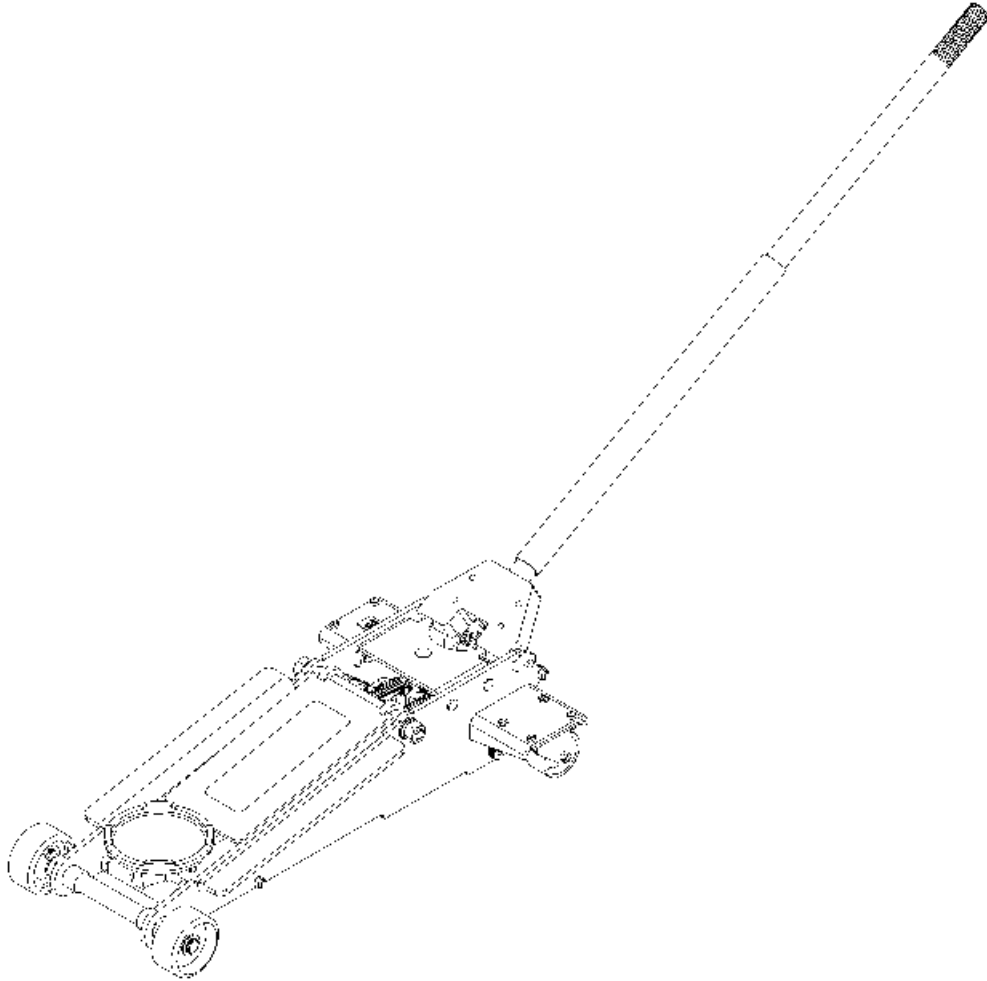

2311 South Park Rd. Louisville, Kentucky 40219

Email: sales@challengerlifts.com Web site: www.challengerlifts.com

Office 800-648-5438 / 502-625-0700 Fax 502-587-1933

**IMPORTANT: READ THIS MANUAL COMPLETELY BEFORE
INSTALLING or OPERATING LIFT**

Table of Contents

Receiving Inspection	2
Introduction	2
Owner and / or Operator Responsibilities	2
Specifications	3
Component Identification	3
Safety Instructions	4
Operating Instructions	5
Initial Operation	5
To Raise A Vehicle.....	5
To Lower A Vehicle	5
Maintenance Instructions	5
Structural Inspection	6
Adding Hydraulic Fluid	6
Troubleshooting	7
Notes	8

Receiving Inspection

Before attempting to operate this jack, thoroughly read and understand this manual. Completely remove all tape and packaging. Inspect the jack immediately upon delivery. If shipping damage is evident, inform the delivering carrier immediately and contact customer service at the numbers and address printed on the back cover of this manual.

Introduction

Owner and / or Operator Responsibilities

The owner and / or user must understand the manufacturer’s operating instructions and warnings before using this jack. Personnel involved in the use and operation of equipment shall be careful, competent, trained, and qualified in the safe operation of the equipment and its proper use when servicing motor vehicles and their components. Warning information should be emphasized and understood.

The owner / manager must make this manual available to all personnel using this jack. They must read and understand the contents of this manual. If the operator is not fluent in English, the manufacturer’s instructions and warnings shall be read to and discussed with the operator in the operator’s native language by the purchaser / owner, making sure that the operator comprehends its contents and observes the proper procedures for use of this jack.

Owner and / or user must study and maintain for future reference the manufacturer’s instructions. Owner and / or user are responsible for keeping all warning labels and instruction manuals legible and intact. Replacement labels and literature are available from the manufacturer.

Specifications

Capacity6,000 lbs. / 2,725 kg.
OperationManual / Hydraulic
Maximum Lift Height23 ¾ inches
Minimum Saddle Height4 ¼ inches

Width.....17 ¼ inches
Chassis Length.....34 ⅜ inches
Weight.....166 lbs.

Component Identification

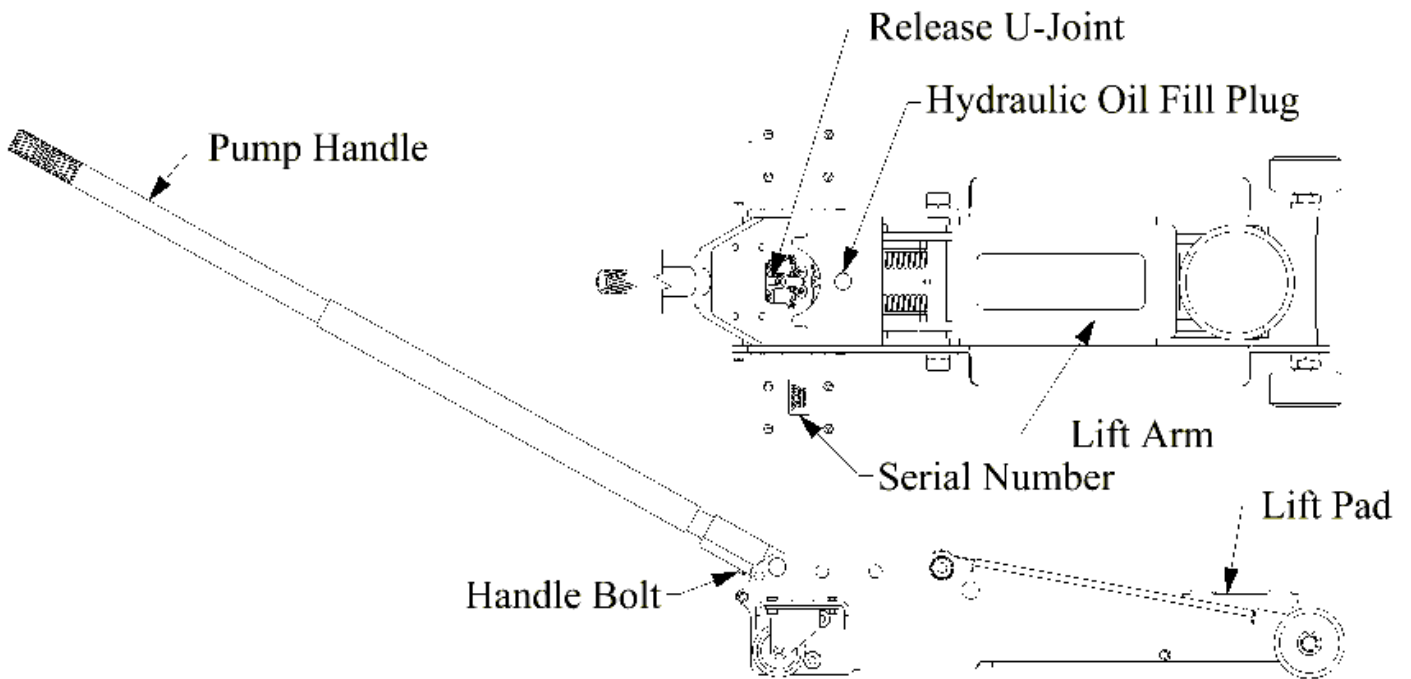

Safety Instructions

⚠ WARNING

To avoid serious injury or death, read this manual carefully before operating this unit. Contact customer service at the numbers and address printed on the back cover of this manual if you have any questions.

Failure to understand and obey safety instructions may result in unsafe or improper use of this product.

1. Maximum capacity is 6,000 lbs. / 2,725 kg. Do not overload.
2. Use this jack only on hard level surfaces capable of sustaining the load. Use on other than hard level surfaces can result in jack instability and possible loss of load.
3. This jack is designed solely for the lifting of vehicles only and must never be used to support a load. Do not use jack as a support stand. Immediately after lifting, support the vehicle with appropriate means.
4. No alterations shall be made to this product.
5. Always lift with the factory supplied lift pad in place. Do not attempt to use any other part of the jack as a lifting point. Do not use any kind of cribbing or adapters with this jack. The jack must remain in direct contact with the floor and the lifting pad must be in direct contact with the vehicle.
6. Lift the vehicle using the vehicle manufacturer's recommended lift points. The lift point must be strong enough to sustain the lifting force without damage to the vehicle. It is necessary to cradle the lifting point in the lift pad to ensure that the selected lift point will not shift or tilt, which could cause loss of load.
7. Make sure the jack is free to roll forward during lifting and backward during lowering. There must not be any wheel obstructions or floor surface irregularities such as uneven expansion joints, gravel, tools, or other obstacles to prevent the jack's wheels from rolling. Load loss can occur during raising or lowering if rolling movement of the jack wheels is impaired.
8. Reposition the jack if the vehicle pulls or pushes the lift arm sideways.
9. After raising a vehicle, never allow any part of your body to pass under it and never begin work on the vehicle until it is properly supported by adequate stands. Once the vehicle is properly supported by adequate stands, the jack must be removed from beneath the vehicle before work on the vehicle begins.
10. Never use more than one jack at the same time to lift a vehicle. If a jack does not have enough capacity to raise a load, remove it and use a jack with adequate capacity. Failure to observe this instruction may lead to unstable or overload conditions that could cause failure of one or both of the jacks.
11. Do not drive the vehicle off of the jack or attempt to move or dolly the vehicle at any time while the jack supports it.

Failure to understand and obey this warning may result in personal injury and / or property damage.

Operating Instructions

Initial Operation

Insert the pump handle and ensure fully engaged with the release U-joint, then tighten the ¼ bolt.

To Raise A Vehicle

To raise a vehicle, close the pump handle by turning it clockwise. Position the lift pad properly to the vehicle and pump the handle while standing clear of the vehicle. Operate the jack to bring the lift pad into light contact with the vehicle beneath a manufacturer's recommended lift point. Check to make sure the lift pad contacts the lift surface squarely and the lift pad cup or lugs engage in a secure manner to prevent lift pad slippage and possible load loss.

Position adequate stands under the vehicle manufacture's recommended lift areas to provide stable support for the raised vehicle. Make sure all personnel are clear of the area. Lower the lift arm slowly by carefully turning the pump handle counterclockwise. When lowering the jack, it is important to keep the rate of lowering under control to assure the recommended vehicle lift points will properly rest on the stand pad. Lower the lift arm until the stands are supporting the entire load. The jack must be removed from the area before work on the vehicle begins.

To Lower A Vehicle

To lower a vehicle, clear the area of personnel, tools, and equipment. Position the jack so the lift pad will contact the vehicle properly. Turn the pump handle clockwise and pump the handle to raise the vehicle. Remove the stands. Carefully turn the pump handle counterclockwise to slowly lower the vehicle to the ground.

For any reason this jack does not operate properly after reviewing the steps above, consult the Troubleshooting section of this manual or contact customer service at the numbers and address printed on the back cover of this manual.

Notice: Any modifications to the jack or damage resulting from the lifting of a vehicle with other than the factory supplied lift pad or adapters shall void all warranties expressed or implied.

Maintenance Instructions

⚠ WARNING

All inspection and maintenance procedures must be performed after the jack has been removed from service. Failure to heed this warning may result in personal and / or property damage.

NOTICE

The owner must inspect, or appoint a knowledgeable person to inspect, the jack. Visual inspection should be made before each use of jack, checking for abnormal conditions. Regular inspections should be made weekly for daily use and monthly for intermittent use. Each jack must be inspected immediately if subjected to an abnormal load or shock. Any jack which appears to be damaged in any way, is found to be badly worn, or operates abnormally shall be removed from service until necessary repairs are made.

1. Check oil level in the oil reservoir. Refer to the “Adding Hydraulic Fluid” section.
2. All warning and capacity labels should be readable and complete. Wash external surfaces of jack, labels, and decals with a mild soap solution. If replacement labels are needed, contact customer service at the numbers and address printed on the back cover of this manual and see parts list.
3. Lubricate all rotating and sliding portions of the jack monthly.

Structural Inspection

⚠ WARNING

The jack must be removed from service and inspected for damage immediately if the jack is subjected to an abnormal shock or load. Failure to heed this warning may result in personal and/or property damage.

NOTICE

The owner must inspect or appoint a knowledgeable person to inspect the jack for signs of corrosion and / or excessive wear. Visual inspection should be made before each use of jack, checking for abnormal conditions. Regular inspections should be made weekly for daily use and monthly for intermittent use. Each jack must be inspected immediately if subjected to an abnormal load or shock. Any jack which appears to be damaged in any way, is found to be badly worn, or operates abnormally shall be removed from service until necessary repairs are made.

1. Inspect lift pad regularly and remove jack from service if it is cracked, chipped or shows signs of excessive wear.
2. The jack should raise and lower smoothly through its full range. Inspect the lift arm for damage such as permanent bends and / or twists.
3. All controls should operate freely. Wheels should rotate freely.
4. Inspect for oil leaks. If oil leaks occur, refer to the “Troubleshooting” section of this manual.

If any irregularities or problems are detected during an inspection, the jack must be removed from service immediately and repaired. Contact customer service at the numbers and address printed on the back cover of this manual.

Adding Hydraulic Fluid

1. Remove the jack from service.
2. The lift arm must be in the fully lowered position and the jack must be on a level surface.
3. Remove the hydraulic oil fill plug, located beneath the hole in the cover plate on the frame of the jack. Removal requires a 7/16” hex socket wrench with 6” extension. Make sure the area around the hydraulic oil fill plug is clean and dry before removing the hydraulic oil fill plug.

4. Check fluid level. The oil should be visible in the hole for the hydraulic oil fill plug. If the fluid level is low, add a high-grade hydraulic fluid equivalent to Tellus T22.

⚠ CAUTION

Do not use brake or transmission fluid. Use of the wrong fluid can deteriorate the seals and corrosion problems will occur. Do not overfill. Overfilling can occur if the arm is raised, the jack is not on a level surface. Overfilling results in oil leaking from the hydraulic oil fill plug until the oil in the reservoir reaches the proper level.

5. Apply teflon paste and secure the hydraulic oil fill plug. Clean up any spilled oil. Test the jack for normal operation.

If the lift pad still doesn't rise to proper height, call customer service at the numbers and address printed on the back cover of this manual.

Troubleshooting

This page is a list of problems and solutions. If the solution listed fails to correct the problem, contact customer service at the numbers and address printed on the back cover of this manual. Please have the model number, and serial number of your jack available. The serial number is located to the rear caster plate on the frame of the jack.

PROBLEM

CAUSE / SOLUTION

Fails to lift load	Low oil level, see the Adding Hydraulic Fluid section of this manual. Release open, turn the pump handle clockwise until tight. Overloaded, use larger capacity jack.
Fails to hold load.....	Release open, turn the pump handle clockwise until tight.
Oil leaks	Hydraulic oil fill plug loose, tighten hydraulic oil fill plug. Reservoir is overfilled.

Model CLHMFSJ-60Q

Notes