



**INSTALLATION & OPERATION MANUAL
SUPPLEMENT**

**MODELS 4030 & 44030
*AIR ACCESSORY KIT (44AK30)***

2311 SOUTH PARK RD LOUISVILLE, KENTUCKY 40219

Email: Challengerlifts@soe.freshdesk.com Phone: 800-648-5438

IMPORTANT: READ THIS MANUAL COMPLETELY BEFORE INSTALLING OR
OPERATING LIFT

Read entire manual before assembling, installing, operating, or servicing this equipment. Proper maintenance and inspection is necessary for safe operation. DO NOT operate a damaged lift.

Air Line Accessory Kit
Installation & Operation Supplement

LAYOUT VIEW

*NOTE:
THIS IS THE RECOMMENDED CONFIGURATION FOR THE AIR
LINES KIT, BUT THE CONFIGURATION COULD VARY DEPENDING
ON CUSTOMER PREFERENCE.

DRILL TWO $\frac{3}{8}$ DIAMETER HOLES TO MATCH HOLE PATTERN ON
ALIF-430-099-XX PNEUMATIC BRACKET. LOCATE BRACKET 48"
FROM BASE PLATE AND CENTERED ON P/U COLUMN.

SPC-6002 CONNECTS TO $\frac{1}{4}$ NPT COUPLINGS LOCATED ON RUNWAYS.

QUICK DISCONNECTS ARE NOT INCLUDED IN AIRLINE KIT.
QUICK DISCONNECTS DEPENDS ON CUSTOMERS PREFERENCES.

UNUSED $\frac{1}{4}$ NPT PORTS REQUIRE $\frac{1}{4}$ MNPT PLUGS.

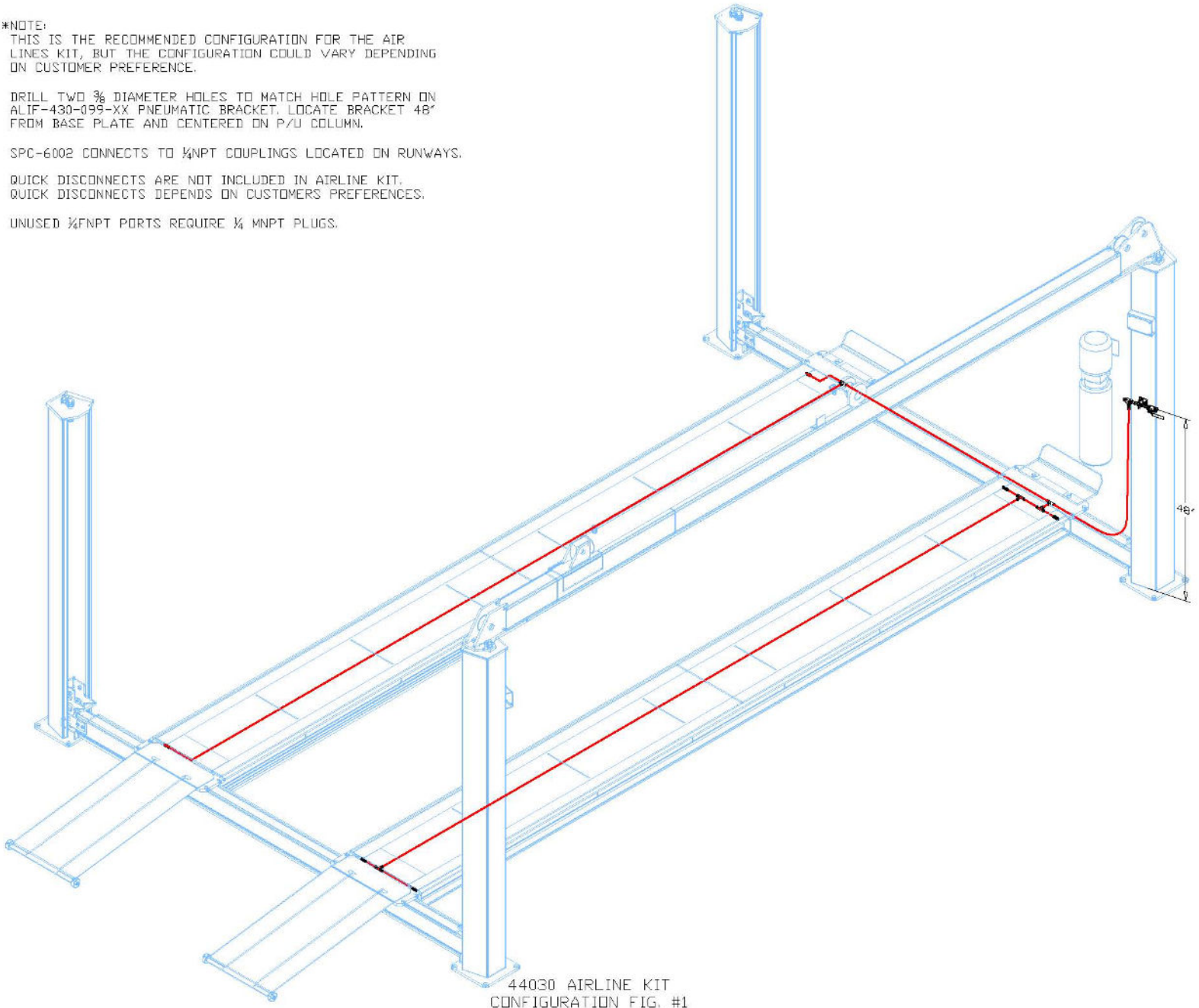

Figure 1

Air Line Accessory Kit
Installation & Operation Supplement

INSTALLATION:

1. Using the pneumatic bracket as a template, drill two Ø3/8" holes centered on the power unit column 48" from the top of the base plate as shown in **Fig 1**. Note: Remove the steel shavings created by drilling the holes before operating the lift.
2. Attach the pneumatic bracket to the column using the provided 5/16-18 hardware. **NOTE:** The head of the bolt should be on the inside of the column, **Fig 3**.

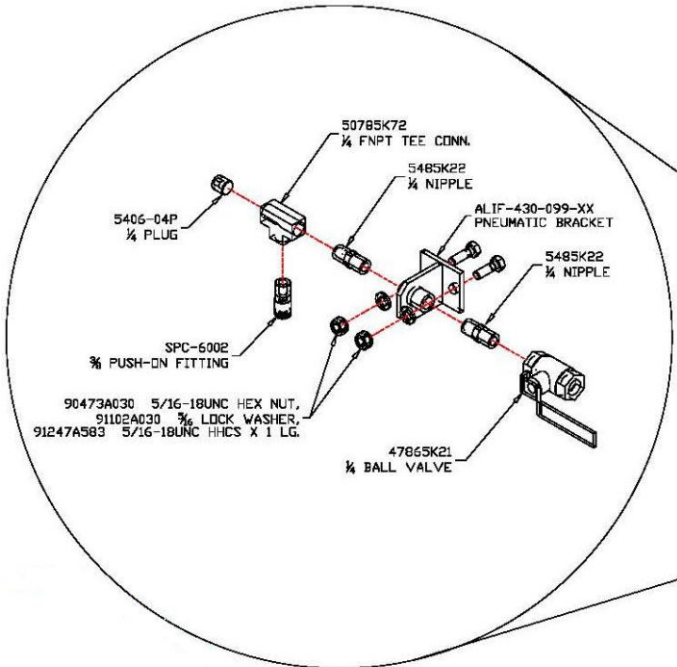

Figure 2

3. Assemble the two 1/4" NPT nipples to the pneumatic bracket as shown in **Fig 2**.
4. Install the 1/4" NPT ball valve on the right side of the bracket assembly.
5. Assemble the 1/4" NPT female tee and (2) 3/8" tube x 1/4" MNPT push fittings on the left side, **Fig 2**.

LOCK RELEASE:

6. If lift has been installed according to the "Installation, Operation, & Maintenance" for Models 44030, 44030E, or 44030X, remove the 1/4" x Male pneumatic hose plug as shown below in **Fig. 3**.

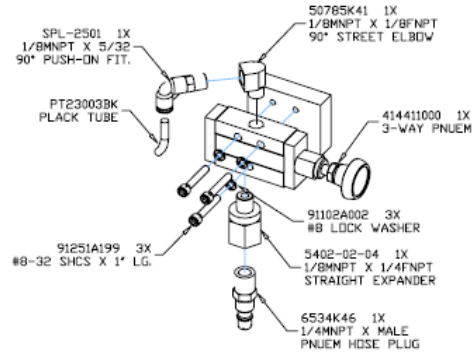

Figure 3

7. Insert 3/8" tube x 1/4" MNPT push fitting into bottom of 3-way pneumatic valve where pneumatic hose plug was removed from.
8. Route 3/8" tube from the push fitting in the 3-way pneumatic valve to the horizontally positioned push fitting in the tee assembly.

TUBE ROUTING:

9. Route 3/8" tube from the vertically positioned push fitting on the tee assembly shown in **Fig 2** to the angle or tube welded to the front crossbeam **Fig 3**.
10. Inside the front passenger side runway install (3) tees and (2) 3/8" tube x 1/4" MNPT push lock fittings to the 1/4" NPT couplings welded to the runway, shown in **Fig 4**.

Air Line Accessory Kit
Installation & Operation Supplement

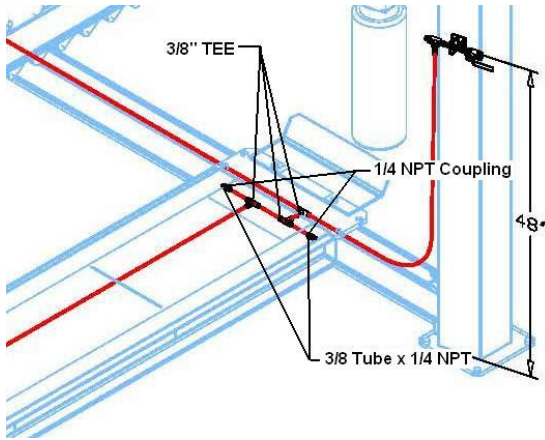

Figure 4

11. Continue to route the 3/8" tube down to the rear of the passenger side runway. Install (1) 3/8" tee with (2) 3/8" tube x 1/4" MNPT push fittings, **Fig 5**. Connect the 3/8" tube x 1/4" MNPT push fittings to the 1/4" NPT couplings.

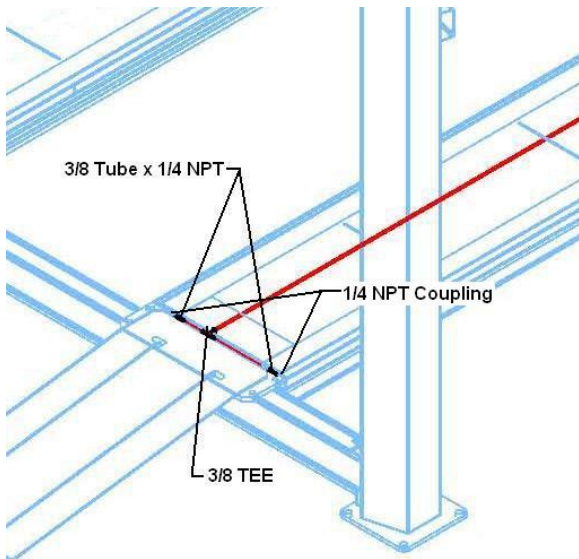

Figure 5

12. Route the 3/8" tube from the 3/8" tee in the passenger side front crossbeam to the 3/8" tee in the front drivers' side runway as shown in **Fig 6**. Connect the 3/8" tube x 1/4" MNPT fitting to the 1/4" NPT coupling welded in the runway.

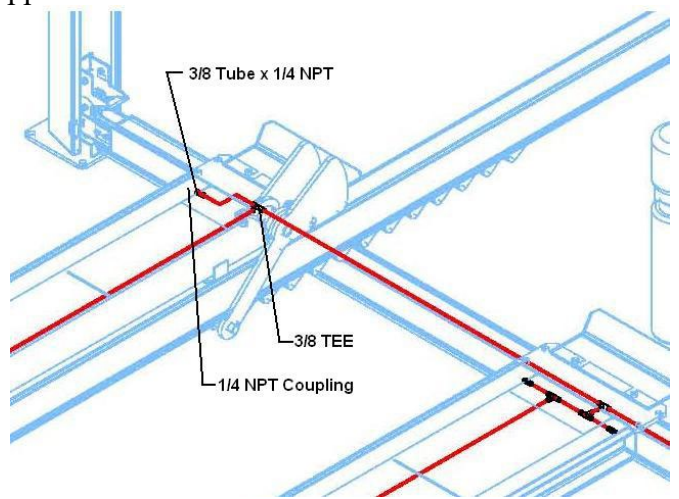

Figure 6

13. Finally, route the 3/8" tube to the rear 1/4" NPT coupling using the 3/8" tube x 1/4" MNPT push fitting, **Fig 7**.

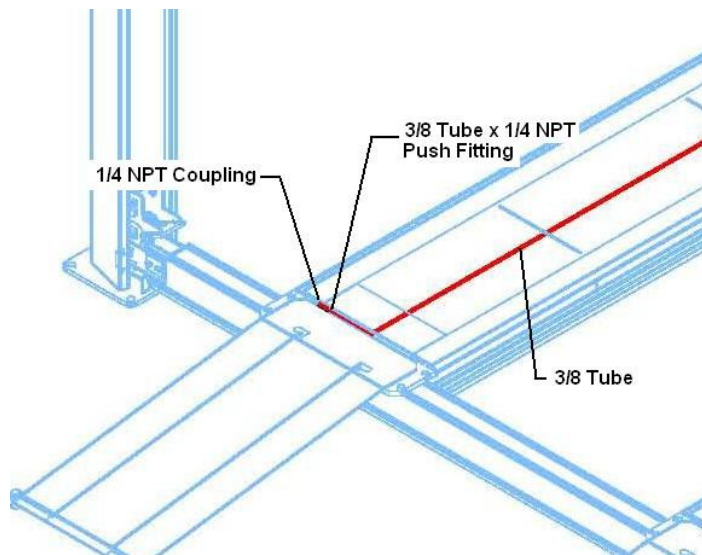

Figure 7

14. If jacks are being used, install 25' long flex coil from couplings on inner edge of passenger side runway to 1/4" FNPT connection on jacks.

15. If jacks are not being used, install 1/4" NPT plugs in unused couplings.

Note: Customer will need to provide (4) 1/4" MNPT quick disconnects or plugs to install at the couplings on the outer edge of the runways.

Air Line Accessory Kit
Installation & Operation Supplement

CABLE INSTALLATION:

16. On the runway with air supply on the inner side, place Cable Bracket on underside of runway as shown in **Fig 7**. Drill 3/8" hole thru I-Beam and secure bracket in place using 5/16"-18 x 1" Lg. hex bolt, hex nut, and lock washer.

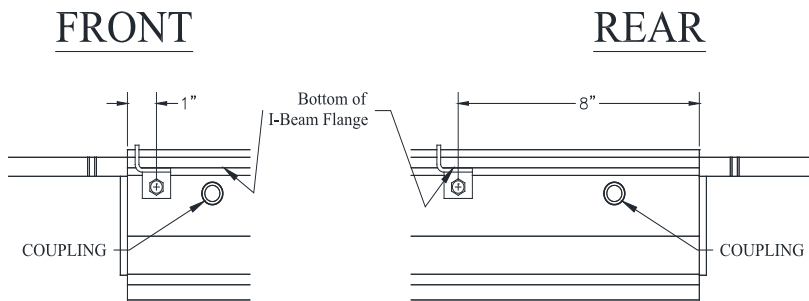

Figure 7

17. Attach threaded end of cable-to-Cable Bracket as shown in **Fig 8**.

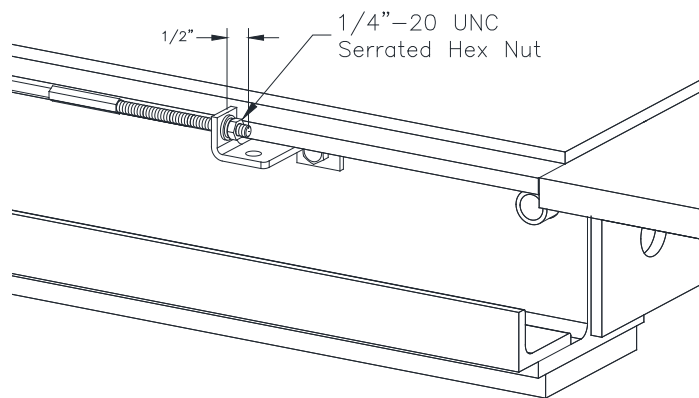

Figure 8

18. Route cable thru both spiral flex air lines. On opposite end of runway, route cable thru hole in Cable Bracket and attach Cable Clamp as shown in **Fig 9**. Trim cable as necessary.

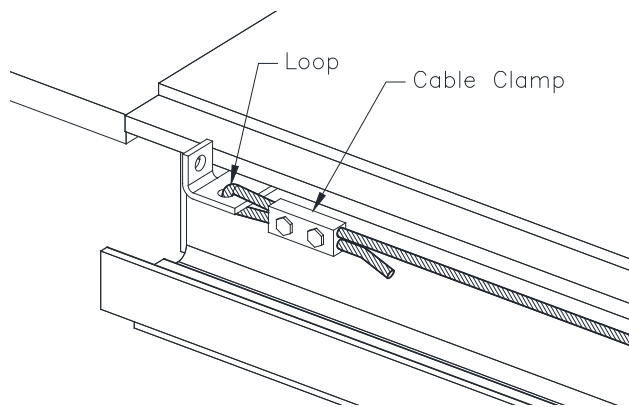

Figure 9

AIR LINE ASSEMBLIES:

19. Cut (2) lengths of 3/8" tubing and attach fittings to ends as shown in **Fig 10**.

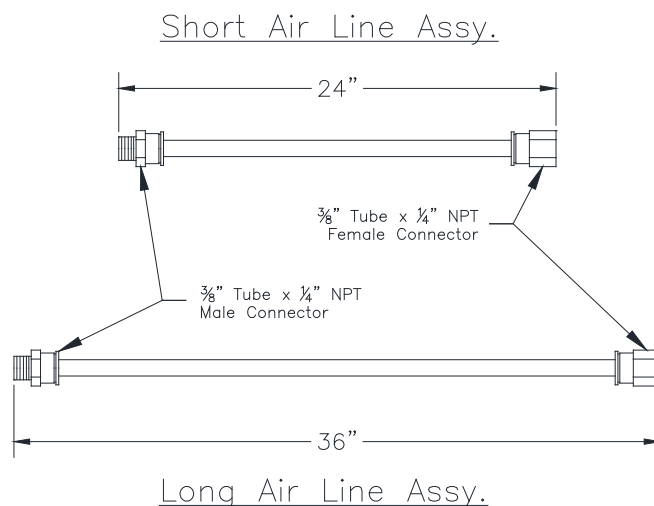

Figure 10

Air Line Accessory Kit
Installation & Operation Supplement

RJAB15 AIR LINE ROUTING:

20. Attach Short Air Line Assembly to spiral flex air line closest to the Jack air connection point. Connect male end to fitting on Jack as shown in **Fig 15**.

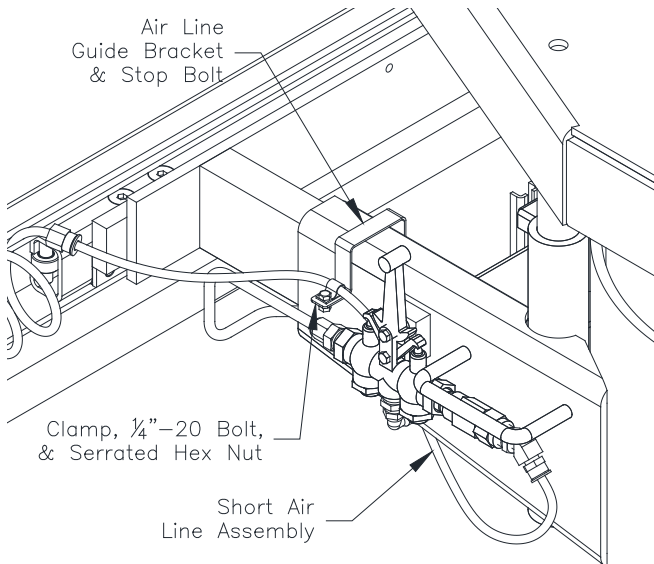

Figure 15

21. Remove Side Member Stop Bolt on the back side of the Jack arm. Install Air Line Guide Bracket and replace bolt. If necessary, adjust both the stop bolts on that end of the jack until both bolts can be tightened down.

22. Using Clamp, 1/4"-20 Hex bolt, and Hex nut, secure tubing to guide bracket. Rotate Clamp as necessary. **Note: Ensure there is clearance between air line and jack rollers during operation.**

23. Repeat procedure for the Long Air Line Assembly as shown in **Fig 16**.

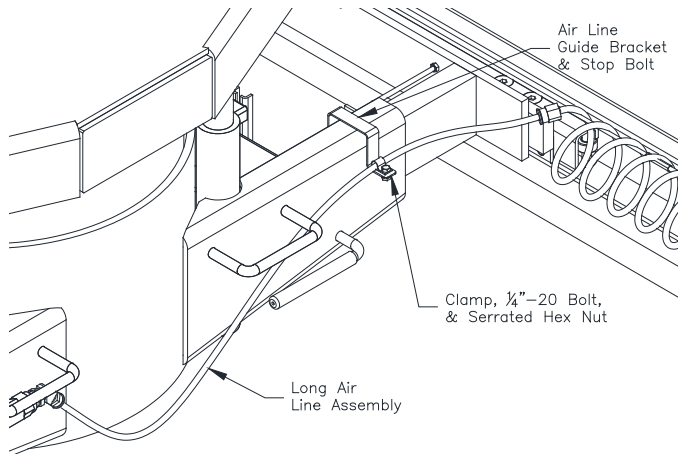
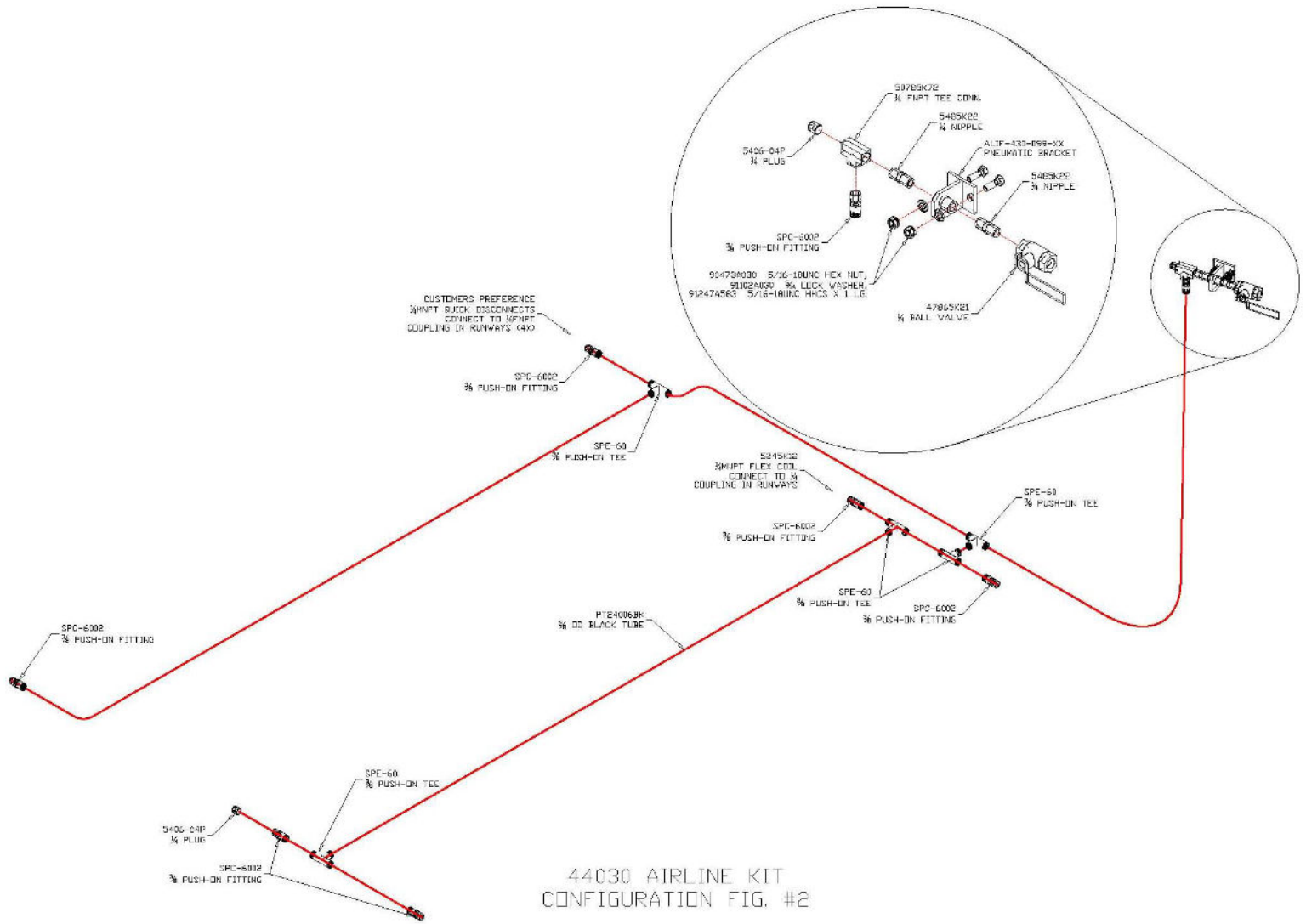

Figure 16

Air Line Accessory Kit
Installation & Operation Supplement
PARTS BREAKDOWN 1 OF 2



44030 AIRLINE KIT
CONFIGURATION FIG. #2

ITEM #	PART #	QTY/LIFT	DESCRIPTION
1	10410-10	1	PNEUMATIC BRACKET WELDMENT
2	31189	2	5/16-18 NUT
3	31331	2	5/16 LOCKWASHER
4	11500	2	5/16-18 x 1" HEX HEAD BOLT
5	5485K22	2	1/4 NPT NIPPLE
6	50785K72	1	1/4 NPT FEMALE TEE
7	47865K21	1	1/4 NPT BALL VALVE
8	5406-04P	3	1/4 NPT PLUG
9	SPC-6002	9	1/4 MNPT x 3/8 TUBE STRAIGHT FITTING, PUSH TO LOCK
10	SPE-60	6	3/8 TUBE TEE, PUSH TO LOCK
11	PT24006BK	80'	3/8 OD TUBE
12	5245K12	2	1/4 MNPT FLEX COIL HOSE (25')

Air Line Accessory Kit
 Installation & Operation Supplement
PARTS BREAKDOWN 2 OF 2

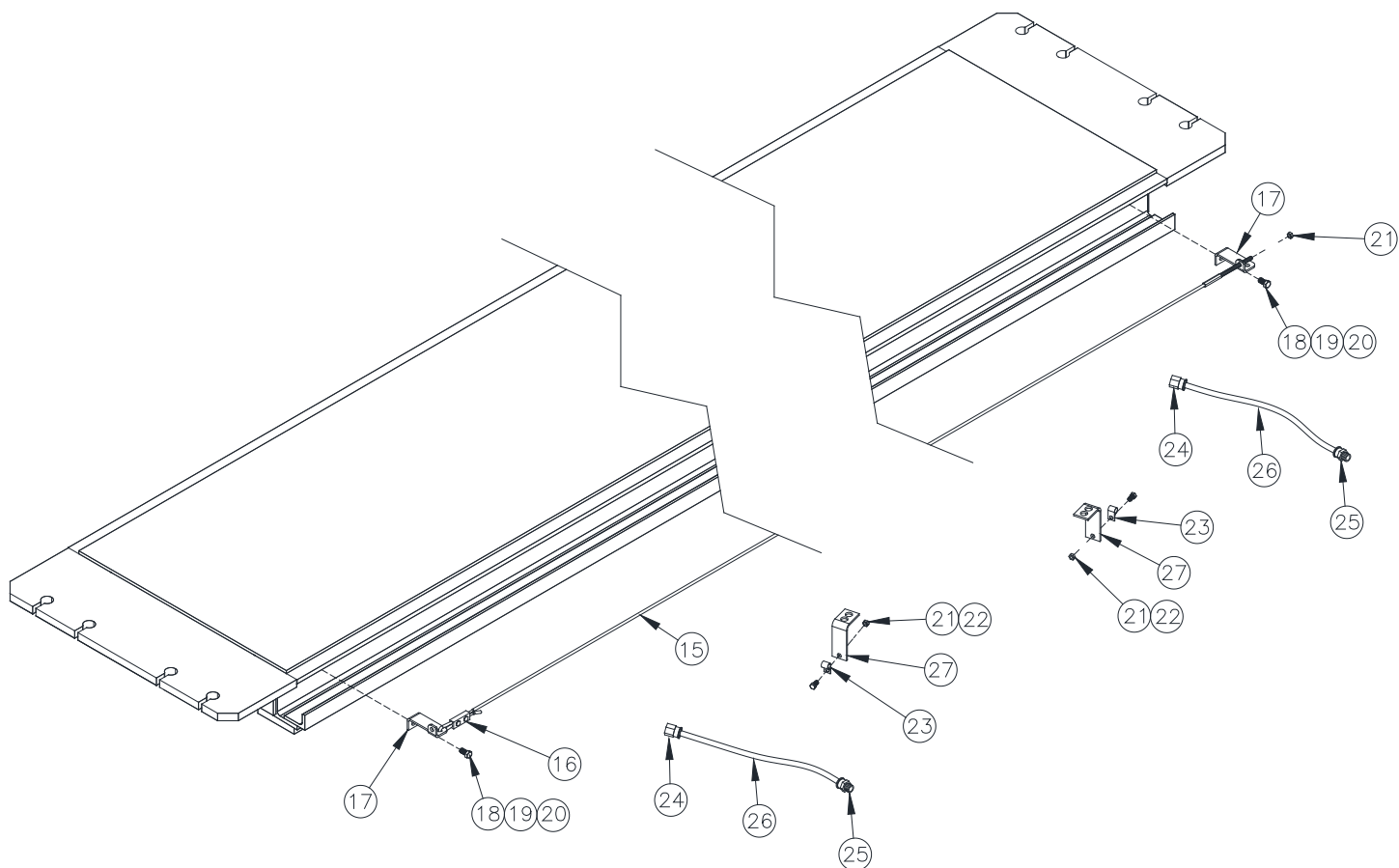

ITEM #	PART #	QTY/LIFT	DESCRIPTION
15	40246	1	CABLE ASSEMBLY
16	40319	1	CABLE CLAMP
17	40317	2	CABLE MOUNTING BRACKET
18	31331	2	5/16 LOCKWASHER
19	11500	2	5/16-18 x 1" HEX HEAD BOLT
20	31189	2	5/16-18 HEX NUT
21	40085	3	1/4"-20 SERRATED HEX NUT
22	A2125	3	1/4" -20 x 3/4" HEX FLANGE HEAD BOLT
23	31025	2	LINE CLAMP
24	40330	2	1/4" FNPT x 3/8" TUBE STRAIGHT FITTING, PUSH TO LOCK
25	SPC-6002	2	1/4" MNPT x 3/8" TUBE STRAIGHT FITTING, PUSH TO LOCK
26	PT24006BK	5'	3/8" OD TUBE
27	40318	2	AIR LINE GUIDE BRACKET

Air Line Accessory Kit
Installation & Operation Supplement
NOTES

Air Line Accessory Kit
Installation & Operation Supplement

REVISIONS

2024/03/27 – UPDATED COVER SHEET, AND UPDATED ADDRESS.

2025/01/07 – UPDATED COVER SHEET TO REMOVE FAX NUMBER ADDED MODEL 4030.