

SRM10 Mobile Power Unit Stand Kit
Installation & Operation Supplement



INSTALLATION & OPERATION MANUAL SUPPLEMENT

MOBILE POWER UNIT STAND

FOR MODEL SRM10

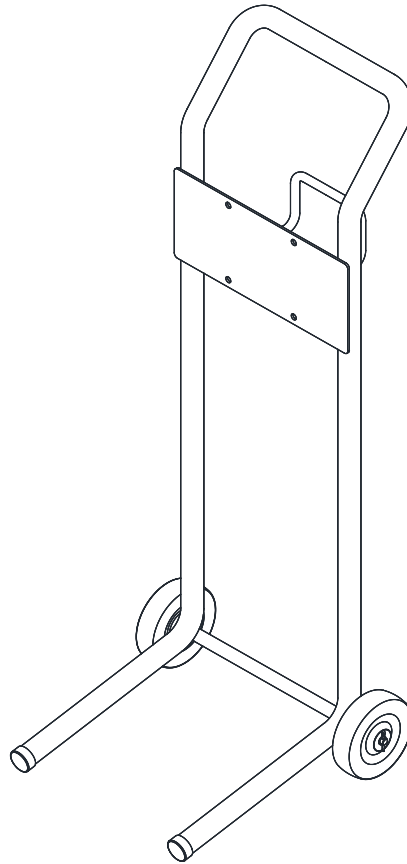

2311 SOUTH PARK RD LOUISVILLE, KENTUCKY 40219

EMAIL: SALES@CHALLENGERLIFTS.COM WEB SITE: WWW.CHALLENGERLIFTS.COM

OFFICE 800-648-5438 / 502-625-0700 FAX 502-587-1933

**IMPORTANT: READ THIS MANUAL COMPLETELY BEFORE
INSTALLING or OPERATING LIFT**

**Read entire manual before assembling, installing, operating, or
servicing this equipment. Proper maintenance and inspection is
necessary for safe operation. DO NOT operate a damaged lift.**

LAYOUT VIEW

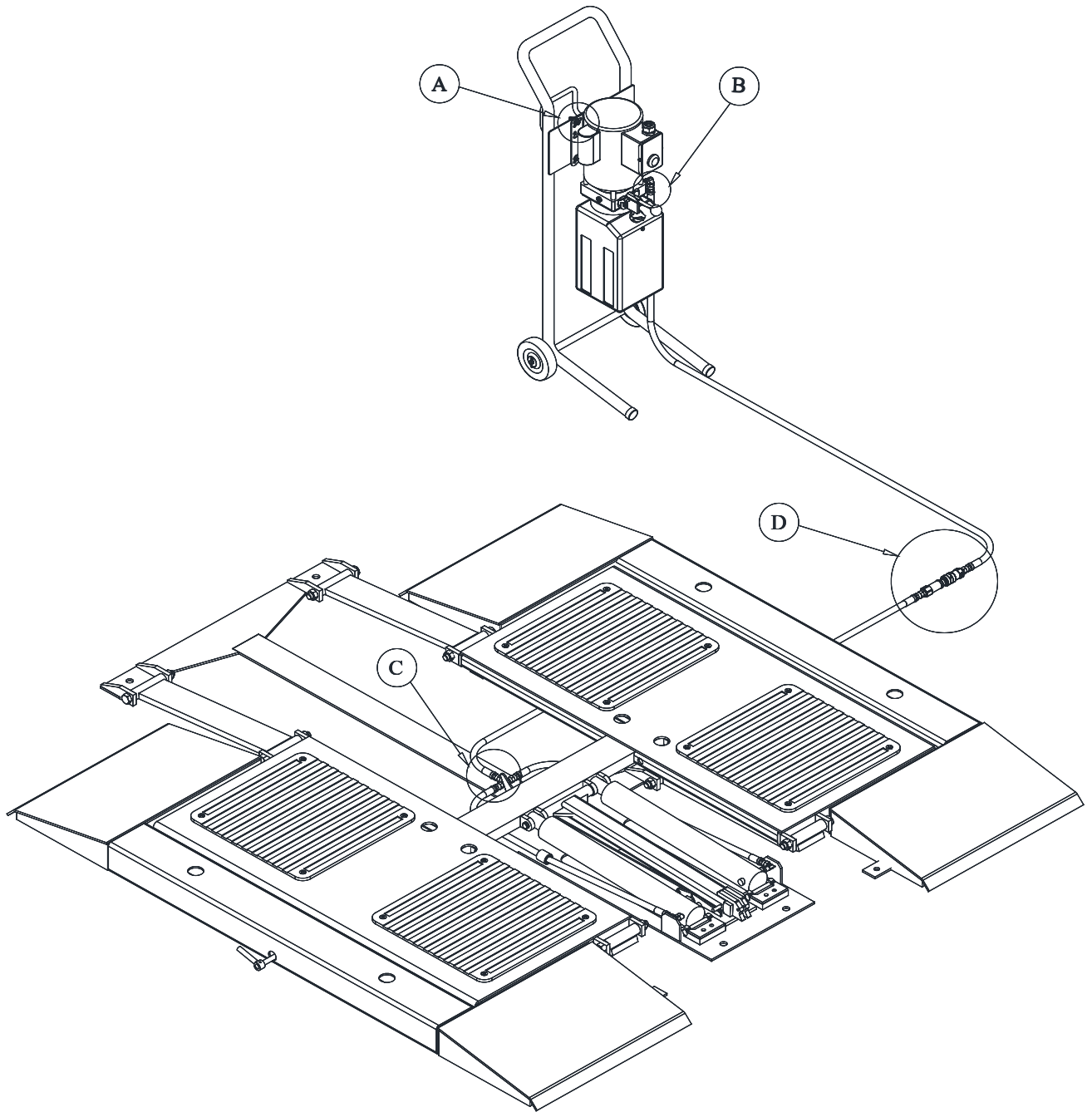
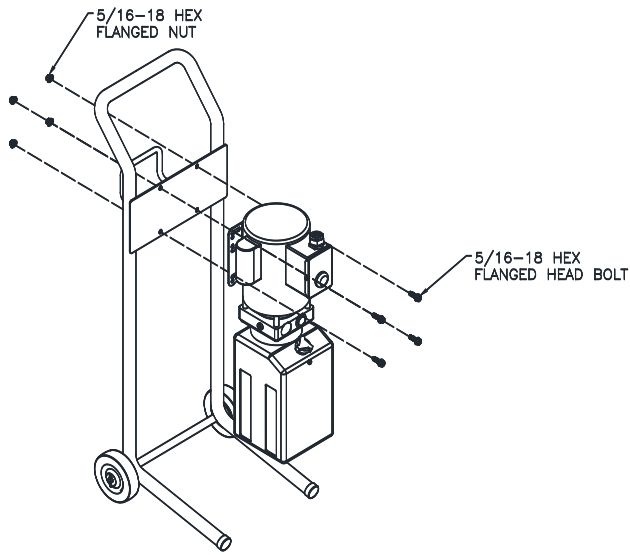

Fig. 1 – Detail View

POWER UNIT INSTALLATION

1. Lay the mobile stand on its back and assemble the power unit to the mobile stand. **Fig 1.**
2. Use four 5/16-18 hex flanged bolts and four 5/16-18 hex flanged nuts to secure the power unit to the mobile stand. As shown in **Detail A.**



Detail A – Power Unit Installation

BML HANDLE INSTALLATION

1. Use a punch and hammer to knock out the 3/16" dia. roll pin. Remove the Standard Lowering Valve Handle. Install the provided BML Lowering Valve Handle (**P/N 16902**) using the same roll pin. **Fig. 2**

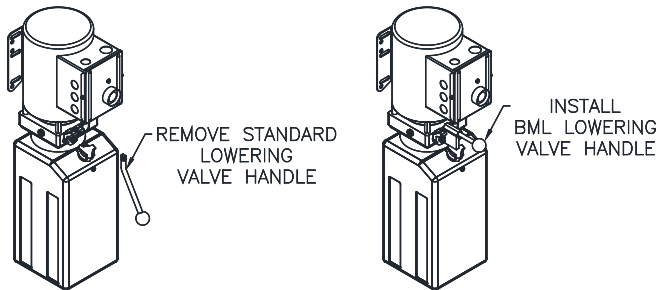
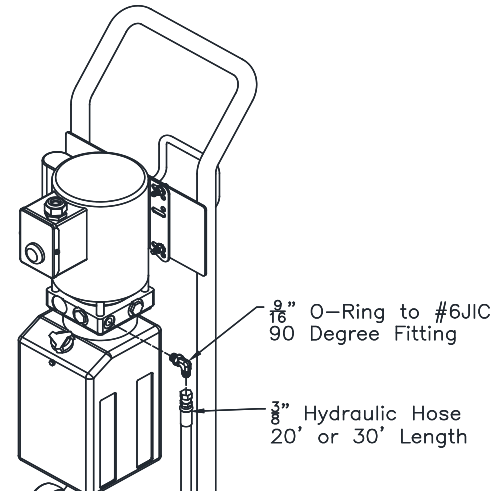

Fig 3 – BML Lowering Valve Handle Install

POWER UNIT HOSE

INSTALLATION

1. Connect the end of the 20ft/30ft hydraulic hose with the 90-degree elbow to the pressure port on the power unit. Tighten securely to prevent leaking. **Detail B.**



Detail B – Power Unit Hose Assembly

2. Connect the other end of the 20ft/30ft hose to the straight JIC straight fitting. Connect the other end of the JIC straight fitting to the female quick disconnect coupler. As shown in **Detail D.**
3. Attach the NR-50 Plug cap to the female quick disconnect coupling. Connect the plug cap when lift is not used to prevent dust from damaging the quick disconnect coupling.

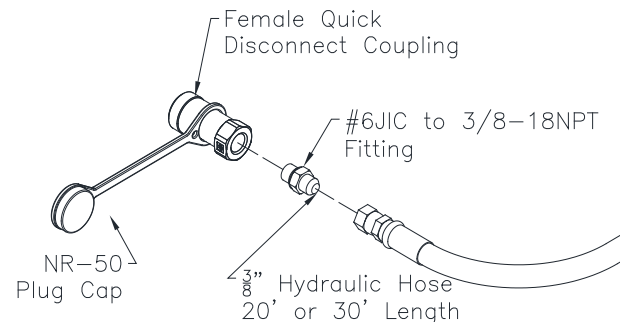

Detail D – Female Quick Disconnect Assembly

LIFT SIDE HOSE INSTALLATION

1. Connect the 5FT hose to the tee fitting on the lift. As shown in **Detail C**.
2. Rout the hose through the hose guide (hole) located on the side of the lift.

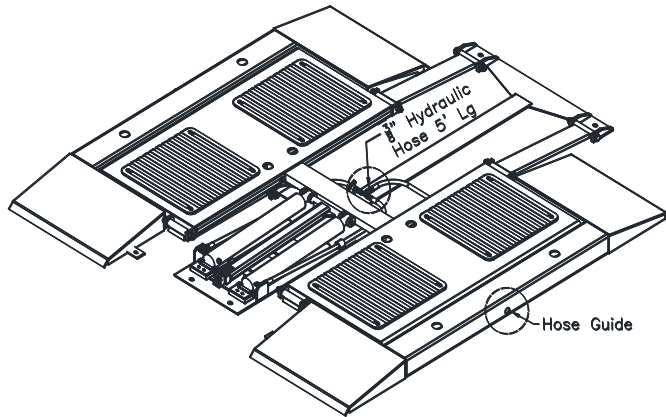

Detail C – Lift Side Hose Installation

3. After guiding the 5FT hose through the hose guide (hole) on the side of the lift, connect the other end of the hose to the straight JIC fitting. Connect the other end of the JIC fitting to the male quick disconnect coupler. As shown in **Detail E**.
4. Attach the NR-37 Plug cap to the male quick disconnect coupling. Connect the plug cap when lift is not used to prevent dust from damaging the quick disconnect coupling.

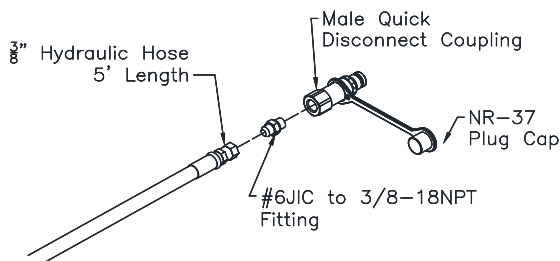

Detail E – Lift Side Hose Assembly

HOSE COUPLING CONNECTION

1. Connect the male quick disconnect coupling to the female quick disconnect coupling. Make sure there is no power before connecting the quick disconnect couplings.

Detail F.

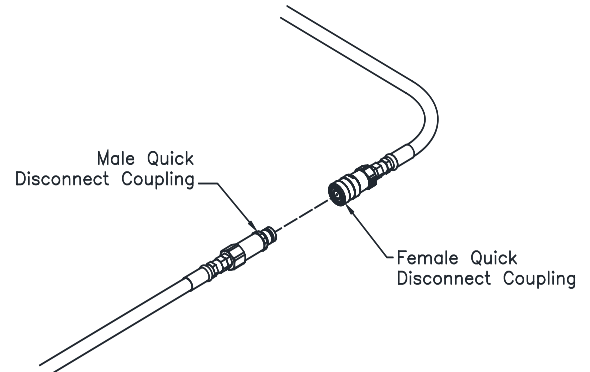

Detail F – Coupling Connection

2. Make sure that the lift is completely lowered before disconnecting the quick disconnect couplings.
3. In case of disconnecting the quick disconnects before completely lowering the lift, simply connect the couplings to relieve the pressure.
4. When the lift is not in use, disconnect the quick disconnect couplings and hang the hose onto the hose hanger on the mobile stand.
5. Make sure to use the caps on both the male and female disconnect couplings to prevent accumulation of dust particles that can damage the couplings.

SRM10 Mobile Power Unit Stand Kit
 Installation & Operation Supplement

Parts Breakdown

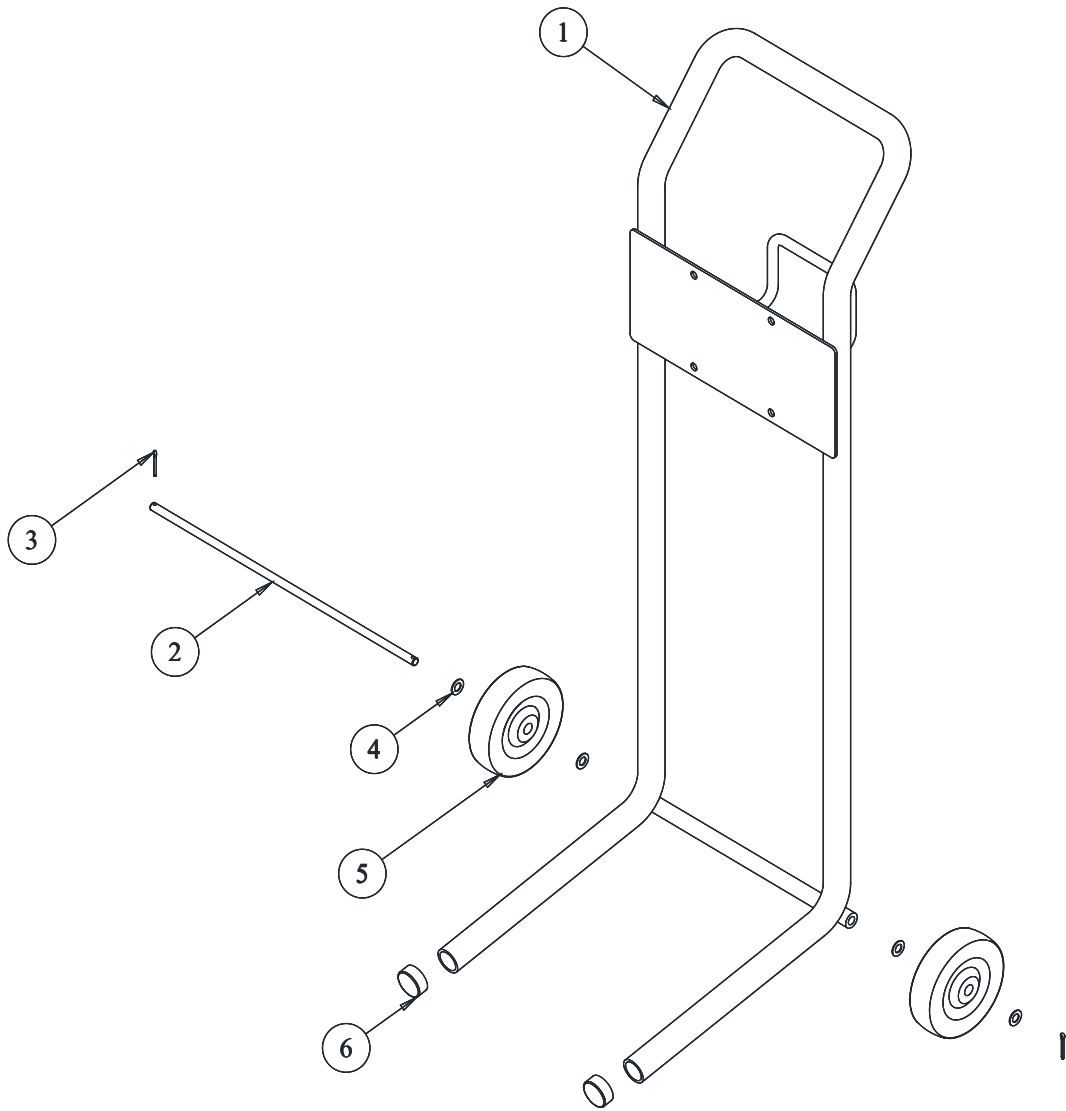

ITEM	QTY	PART NO.	DESCRIPTION
1	1	10603	Mobile PU Stand Weld
2	1	10602-1	Axel Mobile PU Stand
3	2	6-0267	Cotter Pin
4	4	31036	3/8 Flat Washer
5	2	10602-2	Wheel Mobile PU Stand
6	2	10602-3	Round Cap Mobile PU Stand

Replace all worn, damaged, or broken parts with parts approved by **Challenger Lifts Inc.** or with parts meeting **Challenger Lifts Inc.** specifications.

Contact your local Challenger Lifts Parts Distributor for pricing and availability.
(Call Challenger Lifts Inc. (502) 625-0700 for the Parts Distributor in your area)

SRM10 Mobile Power Unit Stand Kit
 Installation & Operation Supplement

Parts Breakdown

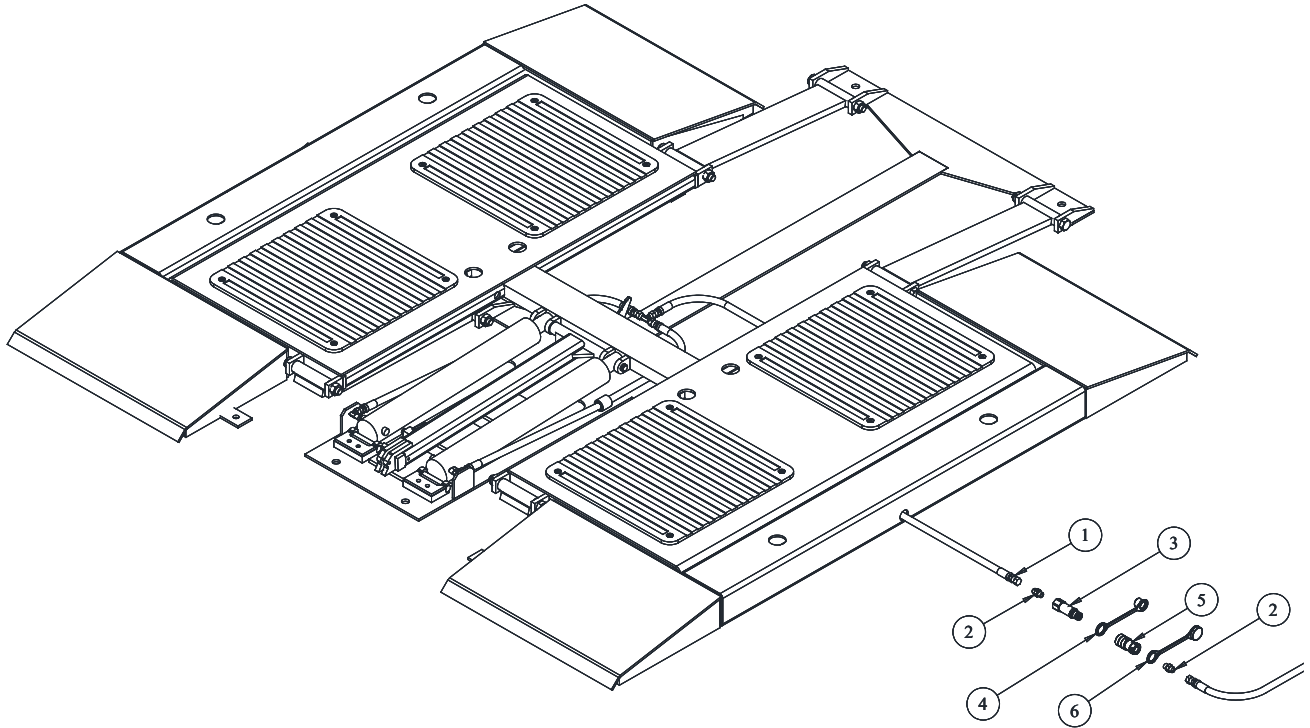

ITEM	QTY	PART NO.	DESCRIPTION
1	1	10601-1	Hyd. Hose Assy (60")
2	2	10601-4	Adapter 3/8NPT Male x #6JIC
3	1	10601-3	Quick Disconnect Male
4	1	10601-6	Plug Cap NR-37
5	1	10601-2	Quick Disconnect Female
6	1	10601-5	Plug Cap NR-50

Replace all worn, damaged, or broken parts with parts approved by **Challenger Lifts Inc.** or with parts meeting **Challenger Lifts Inc.** specifications.

Contact your local Challenger Lifts Parts Distributor for pricing and availability.
(Call Challenger Lifts Inc. (502) 625-0700 for the Parts Distributor in your area)

SRM10 Mobile Power Unit Stand Kit
Installation & Operation Supplement

REVISIONS